



# General Instructions

Western Region  
PO Box 38698  
Seattle, WA 98138  
1-300-456-4226  
www.gaco.com

Central Region  
PO Box 546  
Waukesha, WI 53187  
1-800-331-0196  
www.gaco.com

GW-5-017

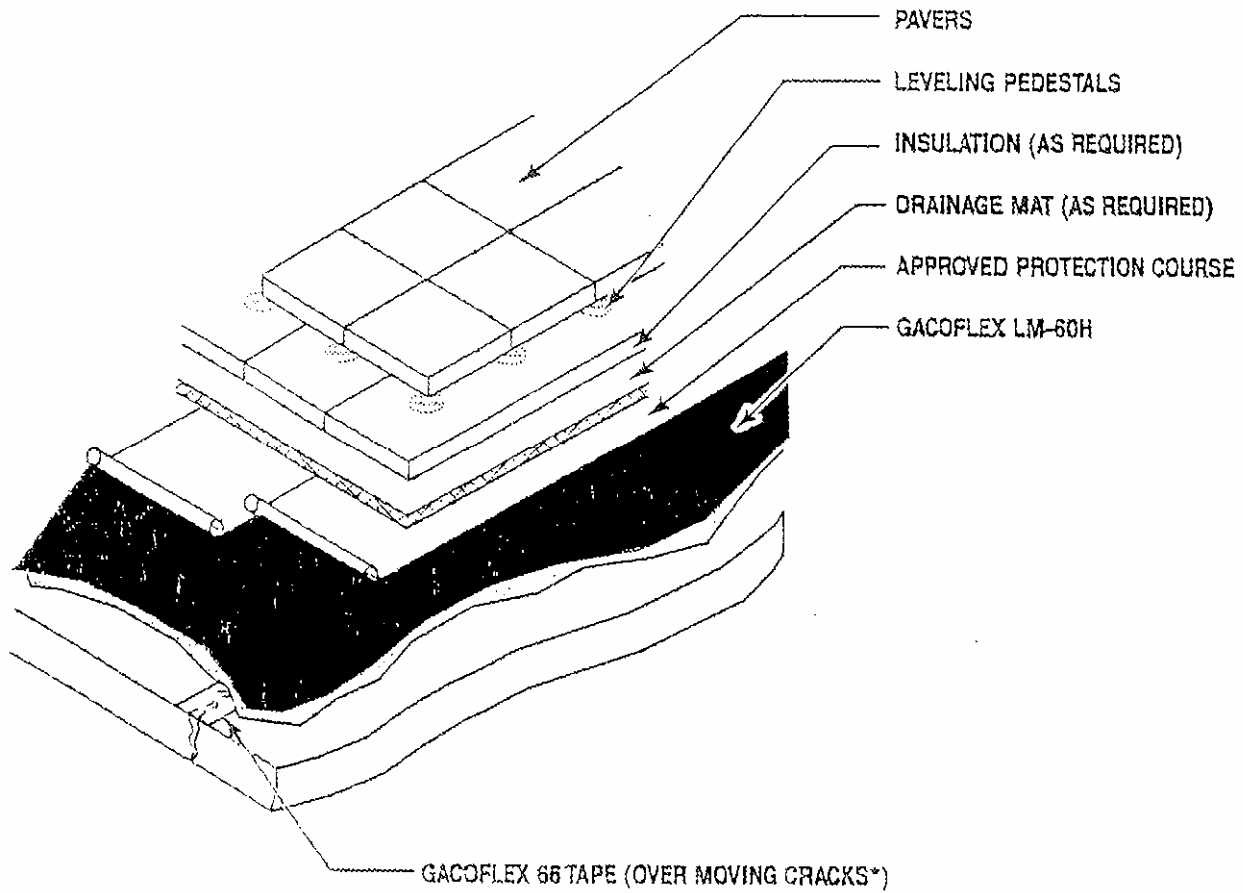

## TYPICAL PLAZA ASSEMBLY

\*SEE SPECIFICATION FOR CRACK TAPING DETAILS.

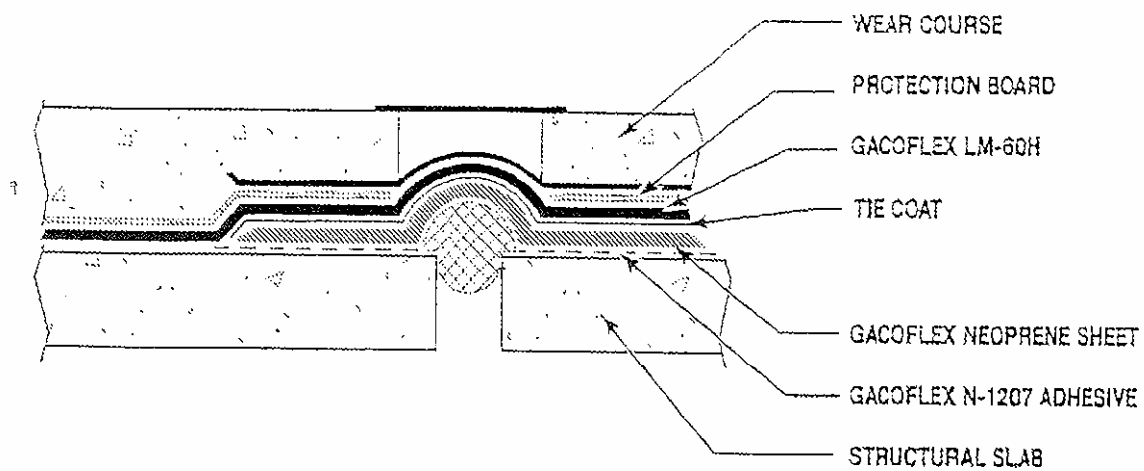

*EXPANSION JOINT*

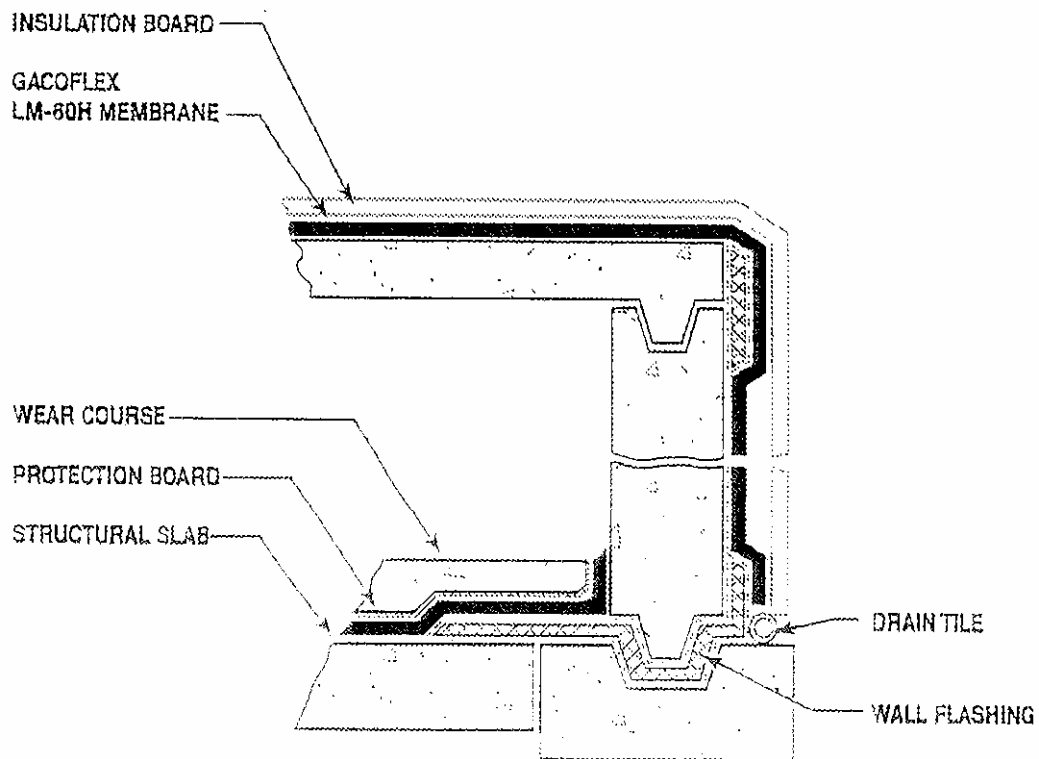

*DETAIL FOR CONCRETE UNDERGROUND STRUCTURES*